



TECHNICAL DATA
FROM
Anemostat[®]
INTERNATIONAL
A MESTEK COMPANY

Kildare House • Wildmere Road
Banbury • Oxfordshire • OX16 3JU • UK
Tel: + 44 1279 812958 • Fax: + 44 1279 817771
e-mail: sales.eu@anemostat.com

LoPro[™]

LO-PROFILE
METAL VISION PANEL

FIRE RATINGS

EN-1634
European Standard

B.S.-476.22
British Standard



UNDERWRITERS'
LABORATORIES



WARNOCK
HERSEY

DETAIL DRAWING

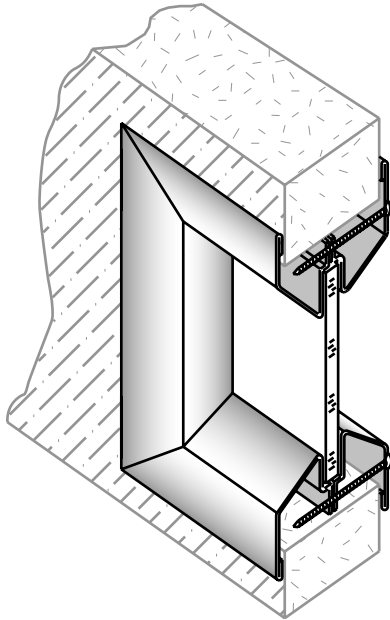

Anemostat manufacturing dimensions ±0.8mm
Actual dimensions are nominal and may vary
based on component manufacturers tolerances.

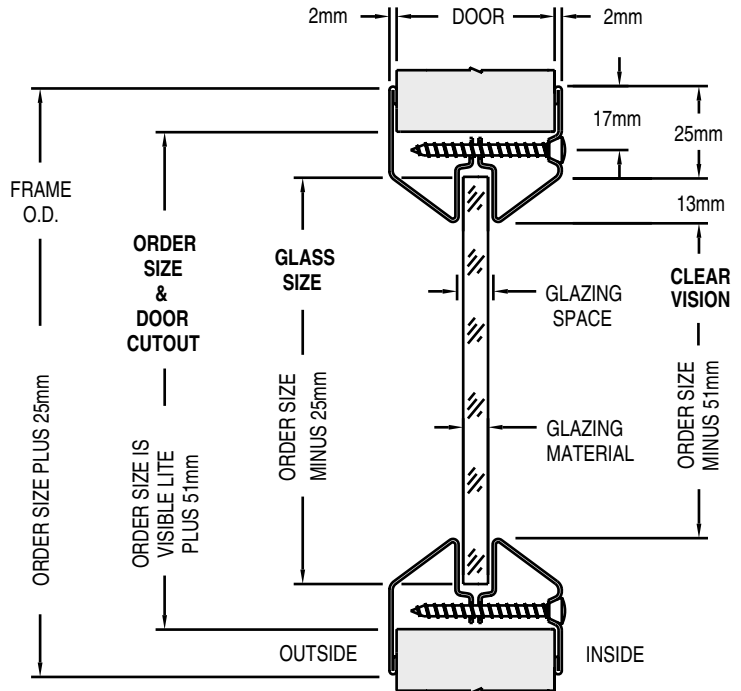

STANDARD PRODUCT FEATURES

- **MATERIAL:** 1mm Galvanised Steel
- **FINISH:** RAL 9006 Silver Baked Enamel
- **INSTALLATION:** Our most popular product is easy to install and provides a low profile, flush to the door look. Uses 44mm sheet metal screws that pass through the door cutout, and fastens to the opposite side of the vision frame, thus eliminating the need to drill holes into door saving installation time and labor. It also leaves the corridor side of the frame free of fasteners for added security and a cleaner, more aesthetic appearance.
- **DOOR THICKNESS:** For 25mm to 82mm Wood or Metal Doors.
- **GLAZING:** 5mm to 27mm Fire and/or Safety Rated glass. Must specify glass and door thickness.
- **AESTHETICS:** Tight mitered corners, beveled glass stop and low profile, provide a clean tapered look.
- **IMPORTANT:** Interpretation of building and fire codes may vary. Consult with the local authority having jurisdiction in your area, to determine appropriate standards.

OPTIONAL FEATURES (SPECIAL ORDER FROM FACTORY)

- **MATERIAL:** #304 or #316 Stainless Steel, #4 Finish (Satin), Galvanised (Coil, Hot Dipped, or Electro Plated) Mill Finish Aluminum-(Not Fire Rated).
- **FINISH:** Custom Baked Enamel Colors (as per sample chip supplied). Plated Finishes to match the lock, hinges and closer.
- **FASTENERS:** Special Security Screw Fasteners
- **SPECIALS:** Fractional Sizes, Lead Lined for X-ray applications. For Special Glass or Door thickness For mullions see (LoPro[™]-G, FGS-75-G or BFL-123-G.)

FIRE RATINGS (BS 476.22 & EN-1634)

- **BS 476.22:** Timber Doors - 30 min. and 1 hour. Tested to 254mm x 762mm Steel Doors - 2 hours (4 hours actual). Tested to 813mm x 813mm
- **EN-1634:** 30/60 min. integrity and insulation - Indicative Testing

FIRE RATINGS (w/ U.L. & W.H.I. classification markings)

- **20 MINUTE:*** Approved listing at 3204 sq.in. (2.067 sq. meters) visible lite max. width 36" (914mm), max. height 89" (2261mm).
- **45/60 MINUTE:*** Approved listing at 2772 sq.in. (1.788 sq. meters) visible lite max. width 36" (914mm), max. height 77" (1956mm).
- **90 MINUTE:*** Approved listing at 1296 sq.in. (0.836 sq. meters) visible lite max. width 36" (914mm), max. height 54" (1372mm).
- **3 Hour:*** Approved listing at 100 sq.in. (0.065 sq. meters) visible lite max. width 12" (305mm), max. height 33" (838mm)

* Must be used with FIRELITE Plus or NT and Fire listed glazing tape and be used in appropriately tested door assembly.

Job Name & Location	Submitted by